



STATE OF NORTH CAROLINA  
DEPARTMENT OF TRANSPORTATION

ROY COOPER  
GOVERNOR

JAMES H. TROGDON, III  
SECRETARY

January 7, 2019

Mr. Tom Steffens  
U.S Army Corps of Engineers  
2407 W. 5<sup>th</sup> Street  
Washington, NC 27889

Subject: As-Built Report for Turner Street Mitigation Project R-3307, Carteret County, TIP Project No. R-3307, USACE Action ID: SAW-2010-02125, NCDWR Project No. 20111003, CAMA Permit 37-12

Dear Mr. Steffens,

Please find enclosed the As-Built Report for the subject mitigation site. The Division 2 Resident Engineer responsible for administering the contract has certified that the site was constructed according to the construction plan sheets, with any exceptions noted in this As-Built Report.

The following information has been included as part of the As-Built Report: 1) As-Built Plan Sheets, 2) Photo Point Locations, 3) Planting Plan and Restoration Detail Sheets. The site will be monitored as described in the associated permit requirements.

When elevation shots were taken to develop the mitigation plan in 2007, 1.4 acres of marsh restoration was initially proposed based on site conditions at the time. When construction of the project began in 2016, it was noted that portions of the proposed site had started to revegetate naturally. After review with the regulatory agencies, this naturally revegetated portion of the site was not graded. Approximately 1.13 acres of the original 1.4 acres has been graded and planted with marsh grasses.

Initial proposed mitigation – 1.4 acres  
Graded and planted area (total) – 1.13 acres  
Area currently debited from site – 0.69 acres  
Area graded and planted outside of bridge footprint – 0.36 acres  
Area graded and planted within bridge footprint – 0.77 acres

*Mailing Address:*  
NC DEPARTMENT OF TRANSPORTATION  
ENVIRONMENTAL ANALYSIS UNIT  
1598 MAIL SERVICE CENTER  
RALEIGH, NC 27699-1598

*Telephone:* (919) 707-6000  
*Fax:* (919) 212-5785  
*Customer Service:* 1-877-368-4968

*Website:* [www.ncdot.gov](http://www.ncdot.gov)

*Location:*  
1020 BIRCH RIDGE DRIVE  
RALEIGH, NC 27610

There has been a hold put on the debit ledger. Final approved mitigation acreages will be computed after the required 5 year monitoring period is complete.

If you should have any questions or require additional information, please contact Mr. Randy Griffin at (919) 707-6121. Thank you once again for your continued support and cooperation.

Sincerely,

DocuSigned by:  
  
8C1643F6874A457...

Philip S. Harris, III, P.E., CPM, Unit Head  
Environmental Analysis Unit

Enclosures

cc: Mr. Monte Matthews, USACE  
Ms. Garcy Ward, NCDWR  
Ms. Amy Chapman, NCDWR  
Ms. Cathy Brittingham, DCM  
Mr. Stephen Lane, DCM  
Mr. Travis Wilson NCWRC  
Mr. Gary Jordan, USFWS  
Mr. Todd Bowers, USEPA  
Mr. David Harris P.E., NCDOT- REU  
Mr. Brad McMannen, PE, NCDOT-Div. 2 Resident Engineer  
Mr. Jay Johnson, NCDOT-Div. 2 Environmental Officer  
Mr. Randy Griffin, NCDOT-NES

TIP PROJECT: R-3307

CONTRACT: C202848

See Sheet 1-A For Index of Sheets  
See Sheet 1-B For Conventional Symbols

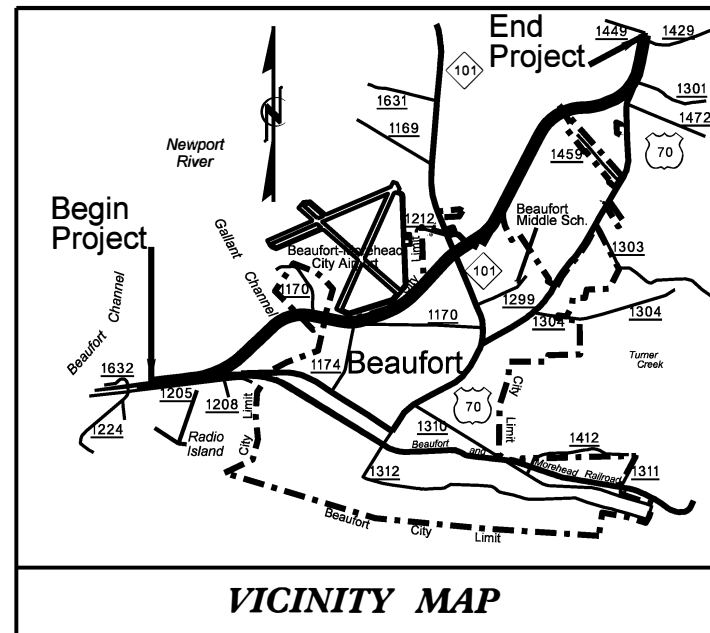

STATE OF NORTH CAROLINA  
DIVISION OF HIGHWAYS  
**CARTERET COUNTY**

LOCATION: US 70 FROM EXISTING FOUR LANES AT RADIO ISLAND  
TO US 70 NORTH OF SR 1429 (OLGA ROAD)

TYPE OF WORK: GRADING, PAVING, DRAINAGE, SIGNALS AND STRUCTURES

**\*AS-BUILT MITIGATION PLANS**

END TIP PROJECT R-3307

-L- PT STA. 207+95.09

END CONSTRUCTION  
-L- POT Sta. 208+76.00

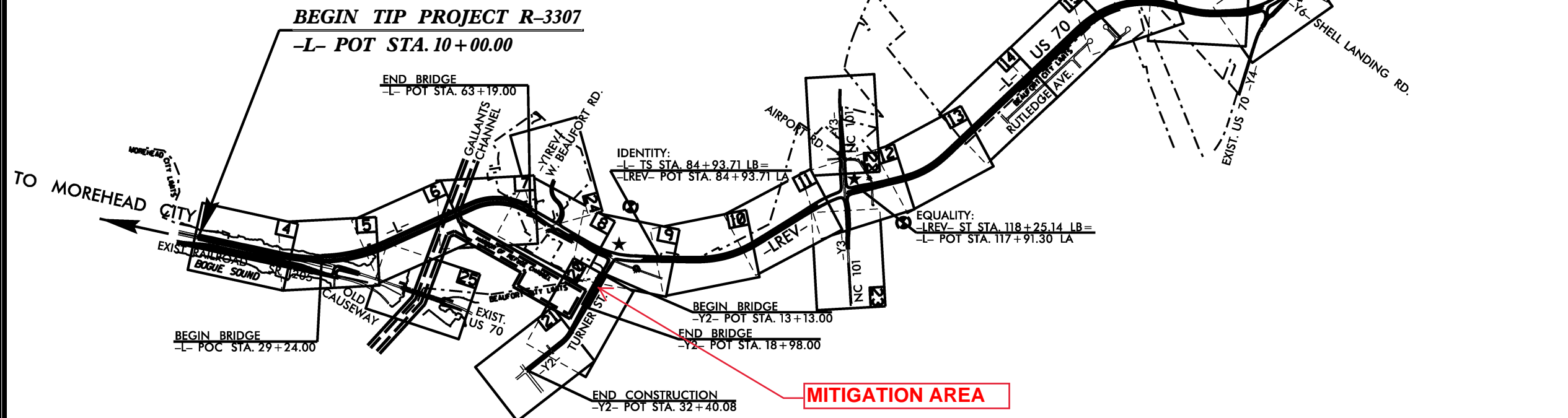

★ PROPOSED TRAFFIC SIGNAL

THIS IS A PARTIAL CONTROLLED-ACCESS PROJECT WITH ACCESS BEING LIMITED TO POINTS AS SHOWN ON THE PLANS.

\*\* DESIGN EXCEPTION REQUIRED FOR HORIZONTAL ALIGNMENT (50 MPH), VERTICAL ALIGNMENT (55 MPH), MAXIMUM GRADE (6%), HORIZONTAL STOPPING SIGHT DISTANCE (38 MPH), AND VERTICAL STOPPING SIGHT DISTANCE (50 MPH).

GRAPHIC SCALES

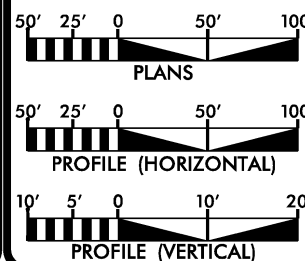

DESIGN DATA

ADT 2014 = 29,385  
ADT 2034 = 41,154  
K = 11 %  
D = 60 %  
T = 5 % \*  
V (SHOULDER) = 60 MPH\*\*  
V (CURB & GUTTER) = 50 MPH  
\* (TTST 1 % + DUAL 4) %  
FUNC. CLASS = ARTERIAL  
STATEWIDE TIER

PROJECT LENGTH

LENGTH ROADWAY TIP PROJECT R-3307 = 3.112 MI.  
LENGTH STRUCTURE TIP PROJECT R-3307 = 0.643 MI.  
TOTAL LENGTH OF TIP PROJECT R-3307 = 3.755 MI.

Prepared in the Office of:  
**DIVISION OF HIGHWAYS**

1000 Birch Ridge Dr., Raleigh NC, 27610

2012 STANDARD SPECIFICATIONS

RIGHT OF WAY DATE:  
JULY 18, 2008

LETTING DATE:  
JANUARY 21, 2014

REKHA PATEL, P.E.  
PROJECT ENGINEER

MICHAEL W. LITTLE, P.E.  
PROJECT DESIGN ENGINEER

HYDRAULICS ENGINEER

SIGNATURE: P.E.

ROADWAY DESIGN  
ENGINEER

SIGNATURE: P.E.

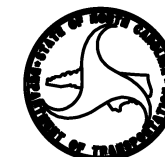



R-3307 Turner Street Mitigation  
As-Built Plans

PP#5  
PP#4

72" CMP  
72" CMP  
72" CMP  
72" CMP

SR 125 TURNER ST

UNKNOWN OWNER

HARBOR OF REFUGE SIGN  
END BRIDGE  
-Y2- POT STA. 18+98.00

PP#3  
PP#2  
PP#1

Original Proposed Mitigation Area  
1.4 Acres

Graded and Planted Mitigation Area  
1.3 Acres

⊕ Photo Point Locations

20+00

-Y2  
+50  
90°

N 09° 17' 31" E

26'

34'

+5.4'

-Y2  
+50  
90°

-Y2  
+50  
100°



PLANTING DETAILS

DOUBLE PLANTING METHOD  
USING THE K3C PLANTING BAR

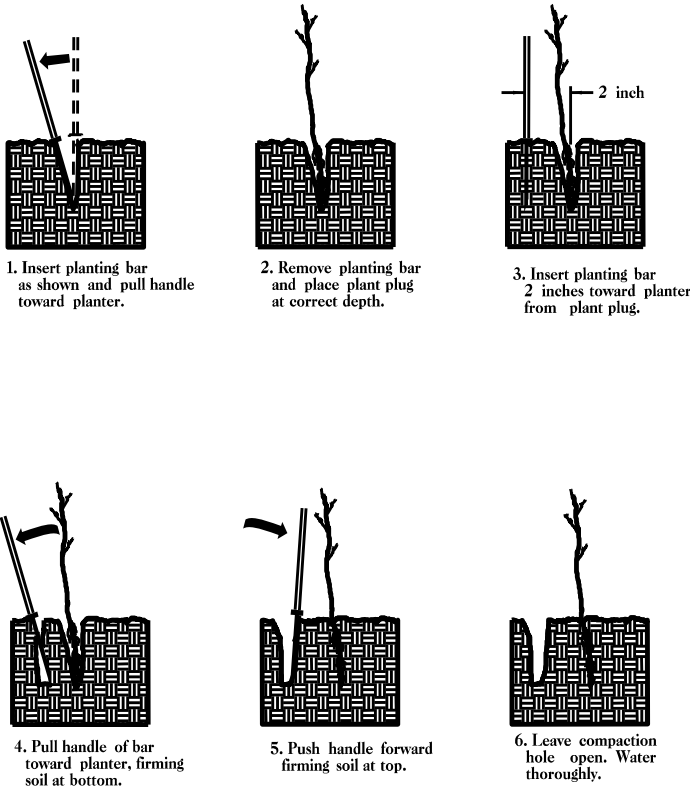

PLANTING NOTES:

PLANTING BAG  
During planting, plant plugs shall be kept in a moist canvas bag or similar container to prevent the root systems from drying.



K3C PLANTING BAR  
Planting bar shall have a blade with a triangular cross section, and shall be 12 inches long, 4 inches wide and 1 inch thick at center.



WETLAND GRASS PLANTING

WETLAND GRASS SPECIES SHALL BE PLANTED 2 FT. TO 4 FT. ON CENTER, RANDOM SPACING, AVERAGING 3 FT. ON CENTER, APPROXIMATELY 4840 PLANTS PER ACRE.

WETLAND GRASS PLANTING

MIXTURE, TYPE, SIZE, AND FURNISH SHALL CONFORM TO THE FOLLOWING:

100% SPARTINA ALTERNIFLORA      SMOOTH CORDGRASS      2 in PEAT POT

WETLAND GRASS PLANTING  
DETAIL SHEET

N.C.DOT - ROADSIDE ENVIRONMENTAL UNIT

PROJECT REFERENCE NO.	SHEET NO.
R-3307	EC-48
RW SHEET NO.	
ROADWAY DESIGN ENGINEER	HYDRAULICS ENGINEER